

DEPARTMENT OF FORESTRY
1234 East Shaw Avenue
Fresno, California 93710
Telephone: (209) 222-3714

Exhibit "A"



October 10, 1980

Odd Fellows Park
23536 Skyview Terrace
Los Gatos, California 95030

Gentlemen:

Re: Timber Harvesting Plan No.: 4-80-167/TU-33
County: Tuolumne
Submitter: Bill A. Pollard
Location: Pors. Secs. 30, T3N, R17E - 31 ac.

Attached is a true copy of your Timber Harvesting Plan as specified above. Determination of conformance of this Plan has been made by the Director and is indicated by the signature of his duly constituted representative being shown on the attached copy of the Plan.

You may, after your stated expected date of commencement, begin the timber operations proposed in the Plan according to the conditions specified therein, and subject to the Forest Practice Act, Forest Practice Rules of the Forest District in which the operation will take place, related Board of Forestry regulations, and other applicable laws, regulations, and ordinances.

This Timber Harvesting Plan has been determined to be in conformance by the Director in accord with the Forest Practice Act, and Board of Forestry regulations pursuant thereto.

The Review Team recommends that this Plan be approved as adequate because the Team found no problems in its review of the Plan.

Very truly yours,

M. O. Schori, Chief
South Sierra Region

By *Daniel T. Seamount*

Daniel T. Seamount
Forester II

DTS:cjr
Attachment
cc: Director
Ranger Unit
✓ Bill A. Pollard, RPF
Mierkey
File

Sierra Forest Management, Inc.

P.O. BOX 296

AVERY, CA 95224

ODD FELLOWS SALE

T. 3N., R. 17E., SEC. 30



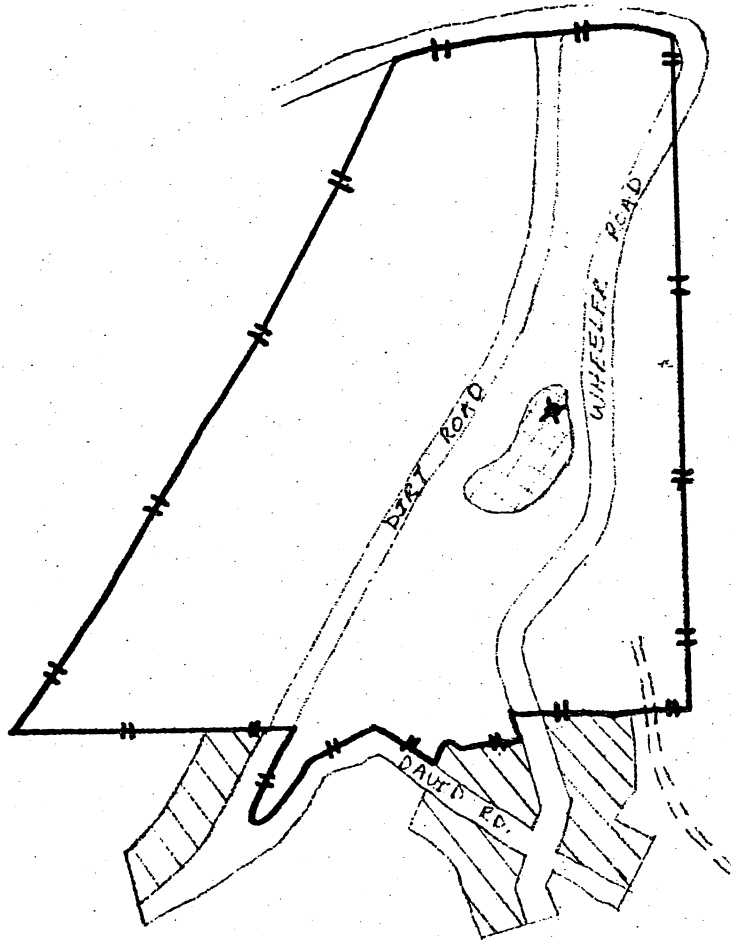

4-80-167/TU-33

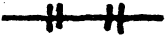
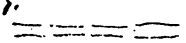
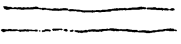

SCALE

1" = 400'

LEGEND

-  HARVEST BOUNDARY
-  SPUR ROAD
-  EXISTING ROAD
-  WET MEADOW
-  CABIN AREA
-  WELL

NORTH

